

BOOM

Concrete, Inc.

Boom Concrete, Inc.
220 Girard Avenue
PO Box 437
Newell, SD 57760

Toll Free: 800-464-2600
Telephone: 605-456-2600
Fax: 605-456-6060
Website: www.boomcon.com
Email: lfox@boomcon.com

BOOM Clovermist Vault Toilets

Boom Concrete, Inc. Clovermist Precast Vault Toilets

PRODUCTS

Aggregates
Benches
Bird Baths
Boat Ramps
Cattle Guard Block
Cisterns
Feed Bunks
Fence
Flower Pots
Fuel Contain. Tanks
Garbage Cans
Lawn Edging
Parking Curbs
Patio Pavers
Picnic Tables
Plinth Blocks
Redi Mix
Retaining Walls
Splash Blocks
Septic Tanks
Steps
Stock Tanks
Storm Shelters
Tile
Well Pits
Vault Toilets



Why purchase a BOOM Precast Concrete Restroom?

- | | |
|--|--|
| <input type="checkbox"/> Vault or Flush Styles | <input type="checkbox"/> Cost Effectiveness |
| <input type="checkbox"/> Vandal Resistance | <input type="checkbox"/> Will Not Rust or Rot |
| <input type="checkbox"/> ADA Compliant | <input type="checkbox"/> Esthetics or Visual Design |
| <input type="checkbox"/> Low Maintenance | <input type="checkbox"/> "Sweet Smelling Technology" |



BOOM

Concrete, Inc.

Boom Concrete, Inc.
220 Girard Avenue
PO Box 437
Newell, SD 57760

Toll Free: 800-464-2600
Telephone: 605-456-2600
Fax: 605-456-6060
Website: www.boomcon.com
Email: lfox@boomcon.com

BOOM Clovermist Vault Toilets

PRODUCTS

- Aggregates
- Benches
- Bird Baths
- Boat Ramps
- Cattle Guard Block
- Cisterns
- Feed Bunks
- Fence
- Flower Pots
- Fuel Contain. Tanks
- Garbage Cans
- Lawn Edging
- Parking Curbs
- Patio Pavers
- Picnic Tables
- Plinth Blocks
- Redi Mix
- Retaining Walls
- Splash Blocks
- Septic Tanks
- Steps
- Stock Tanks
- Storm Shelters
- Tile
- Well Pits
- Vault Toilets

Clovermist STD



Clovermist PLUS



Clovermist DOUBLE



BOOM

Concrete, Inc.

Boom Concrete, Inc.
220 Girard Avenue
PO Box 437
Newell, SD 57760

Toll Free: 800-464-2600
Telephone: 605-456-2600
Fax: 605-456-6060
Website: www.boomcon.com
Email: lfox@boomcon.com

Boom Clovermist Vault Toilet

PRODUCTS

- Aggregates
- Benches
- Bird Baths
- Boat Ramps
- Cattle Guard Block
- Cisterns
- Feed Bunks
- Fence
- Flower Pots
- Fuel Contain. Tanks
- Garbage Cans
- Lawn Edging
- Parking Curbs
- Patio Pavers
- Picnic Tables
- Plinth Blocks
- Redi Mix
- Retaining Walls
- Splash Blocks
- Septic Tanks
- Steps
- Stock Tanks
- Storm Shelters
- Tile
- Well Pits
- Vault Toilets



Replace this...
with a **BOOM!**



BOOM

Concrete, Inc.

Boom Concrete, Inc.
220 Girard Avenue
PO Box 437
Newell, SD 57760

Toll Free: 800-464-2600
Telephone: 605-456-2600
Fax: 605-456-6060
Website: www.boomcon.com
Email: ifox@boomcon.com

Clovermist Precast Concrete Vault Toilets

PRODUCTS

Aggregates
Benches
Bird Baths
Boat Ramps
Cattle Guard Block
Cisterns
Feed Bunks
Fence
Flower Pots
Fuel Contain. Tanks
Garbage Cans
Lawn Edging
Parking Curbs
Patio Pavers
Picnic Tables
Plinth Blocks
Redi Mix
Retaining Walls
Splash Blocks
Septic Tanks
Steps
Stock Tanks
Storm Shelters
Tile
Well Pits
Vault Toilets



BOOM Concrete, Inc. is a manufacturer of Precast Concrete toilets, buildings, septic tanks, cisterns, well pits, and landscaping products. All of our products are designed and built with high quality components in a climate controlled facility located in Western South Dakota.

The CLOVERMIST:

The BOOM Clovermist line of vault toilets come in single and double toilets with a wide range of styles and appearance options available to blend in to any landscape. The toilets are precast in several sections and assembled into a complete one piece unit. It is off-loaded into your excavated site and is ready to use in just minutes.

ADA COMPLIANCE:

BOOM Clovermist vault toilets are designed to comply with ADA accessibility requirements for persons with disabilities. The comfort station is equipped with two grab bars, a handicap toilet riser, assessable doors and 60-inch turning space to accommodate a wheelchair.



BOOM

Concrete, Inc.

Boom Concrete, Inc.
220 Girard Avenue
PO Box 437
Newell, SD 57760

Toll Free: 800-464-2600
Telephone: 605-456-2600
Fax: 605-456-6060
Website: www.boomcon.com
Email: lfox@boomcon.com

Clovermist Precast Concrete Vault Toilet

PRODUCTS

Aggregates
Benches
Bird Baths
Boat Ramps
Cattle Guard Block
Cisterns
Feed Bunks
Fence
Flower Pots
Fuel Contain. Tanks
Garbage Cans
Lawn Edging
Parking Curbs
Patio Pavers
Picnic Tables
Plinth Blocks
Redi Mix
Retaining Walls
Splash Blocks
Septic Tanks
Steps
Stock Tanks
Storm Shelters
Tile
Well Pits
Vault Toilets

LOW MAINTENANCE COSTS:

The BOOM Clovermist is constructed out of precast concrete so there is little chance of damage or decay. The interior walls are a smooth, stained and sealed white epoxy surface that can be easily hosed out, thoroughly cleaned, and are vandal resistant. Doors, door frames, and window frames are factory powder coated in teakwood brown. The standard exterior walls have an exposed aggregate finish for a pleasing look that goes with most landscapes. Several other exterior finishes are available. The BOOM Clovermist will withstand the most extreme conditions that Mother Nature can throw at it and come out looking like new for years to come.

SWEET SMELLING TECHNOLOGY - "NEW AND IMPROVED"

The US Forest Service developed the "Sweet Smelling Technology" which is a unique design for controlling odors in vault toilets. BOOM Concrete has enhanced these design elements in order to greatly improve the concepts of "Sweet Smelling Technology" which has made the BOOM Clovermist completely odor free. There is a noticeable difference between the BOOM Clovermist and other vault toilets on the market. The key to "Sweet Smelling Technology" is the one directional movement of fresh air into the toilet, through the toilet riser into the storage vault. This fresh air then mixes with the toilet odors and exits the toilet through the vent pipe. This system uses Mother Nature's natural powers of the sun and the wind to keep the positive airflow and odor moving in the right direction. And this is where the BOOM Clovermist has teamed up with Mother Nature by designing a solar heat chamber into the dark colored concrete roof of the BOOM Clovermist. The sun's rays heat up the concrete that surrounds the heat chamber causing the warm air to rise out the vent. This enhanced positive airflow through the toilet eliminates all obnoxious odors in the interior of the toilet that were once associated with the previous style outhouse.



BOOM

Concrete, Inc.

Boom Concrete, Inc.
220 Girard Avenue
PO Box 437
Newell, SD 57760

Toll Free: 800-464-2600
Telephone: 605-456-2600
Fax: 605-456-6060
Website: www.boomcon.com
Email: ifox@boomcon.com

Boom Clovermist Standard

BOOM Clovermist Vault Toilet Pricing and Options

Clovermist STD single precast concrete vault toilet with optional Colonial Dry Stack or Barnwood outside finish. Smooth interior walls will have two coats of modified acrylic water repellent penetration stain followed by one coat of anti-graffiti sealer, and a tan epoxy nonslip floor. Includes a 20" X 36" Lexon window and 18 ga. metal door. Doors and frames come factory powder coated teakwood brown. Improved "Sweet Smelling Technology" design eliminates all odor associated with outdoor toilets. The Clovermist meets ADA accessibility requirements for persons with disabilities and has a 60" turning circle. Comes with a 7' by 5' concrete entry slab. Unit will be offloaded and set into owner supplied excavated hole at jobsite.



SIN # 361-10H
BOOM Clovermist Standard Vault Toilet
Additional Options:

Commercial Price
\$9,000.00

Double Plastic Vault Liner



Waste Receptacle



Plastic Urinal



Raptor Screen



1 Qt. Paint Kit



Solar Vent Fan

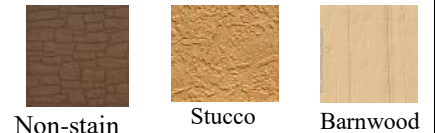

Non-stain Colonial

Stucco

Barnwood

Solar Light Kit



Chain Door Strap



Cleanout Locking Bar



Gojo Purell Hand Dispenser



Call for quote on transportation costs from Newell, SD
 GSA Contracts will receive a 3% discount on less than 10 units, 5% discount on greater than 10 units.
 Prices effective January 1, 2016

BOOM

Concrete, Inc.

Boom Concrete, Inc.
220 Girard Avenue
PO Box 437
Newell, SD 57760

Toll Free: 800-464-2600
Telephone: 605-456-2600
Fax: 605-456-6060
Website: www.boomcon.com
Email: kcr@boomcon.com

Boom Clovermist Plus

BOOM Clovermist Vault Toilet Pricing and Options

Clovermist STD single precast concrete vault toilet with optional Colonial Dry Stack or Barnwood outside finish. Smooth interior walls will have two coats of modified acrylic water repellent penetration stain followed by one coat of anti-graffiti sealer, and a tan epoxy nonslip floor. Includes a 20" X 36" Lexon window and 18 ga. metal door. Doors and frames come factory powder coated teakwood brown. Improved "Sweet Smelling Technology" design eliminates all odor associated with outdoor toilets. The Clovermist meets ADA accessibility requirements for persons with disabilities and has a 60" turning circle. Unit will be offloaded and set into owner supplied excavated hole at jobsite. The Clovermist Plus features a privacy screen and cedar shingle gable roof with 7/12 pitch.



Commercial Price
\$14,000.00

SIN # 361-10H
BOOM Clovermist Plus Vault Toilet
Additional Options
Listed Below:

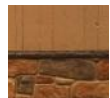

Barnwood/Stained
Colonial Dry Stack



Board & Batt
w/ Lap Siding



Non-stain
Colonial



Medium
Flagstone



Stucco



Barnwood

Double Plastic Vault
Liner



Waste
Receptacle



Plastic
Urinal



Raptor
Vent



1 Qt. Pair
Kit



Solar Fan



Solar Light Kit



Chain Door Strap



Gojo Purell Hand
Sanitizer Dispenser



Call for quote on transportation costs from Newell, SD
 GSA Contracts will receive a 3% discount on less than 10 units, 5% discount on greater than 10 units.
 Prices effective January 1, 2016

BOOM

Concrete, Inc.

Boom Concrete, Inc.
220 Girard Avenue
PO Box 437
Newell, SD 57760

Toll Free: 800-464-2600
Telephone: 605-456-2600
Fax: 605-456-6060
Website: www.boomcon.com
Email: lfox@boomcon.com

Boom Clovermist PLUS Floor Plans



Replace this...
with a BOOM!

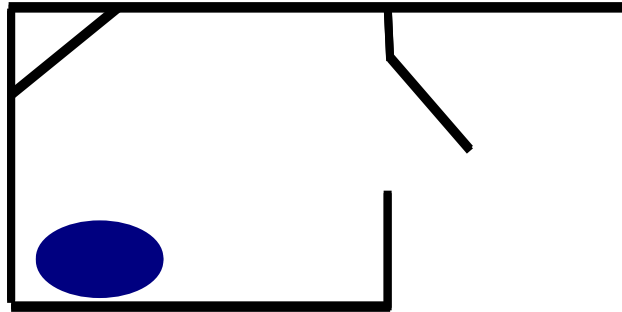

Right-Hand Floor

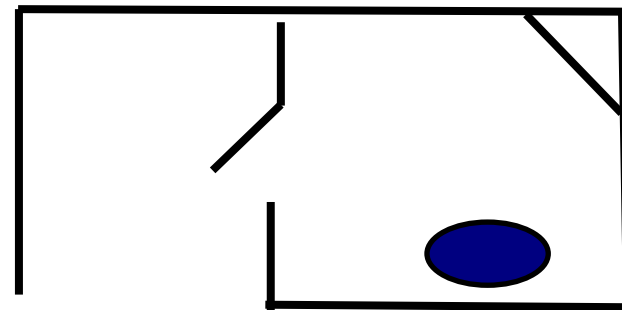

Left-Hand Floor

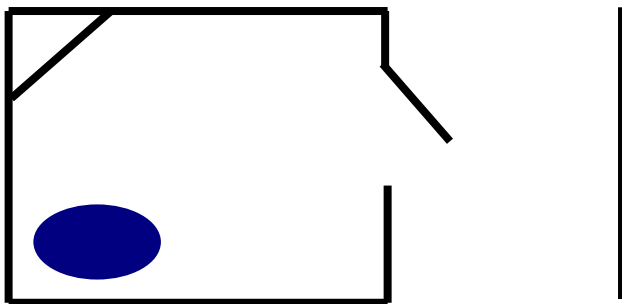

Right Thru-Floor

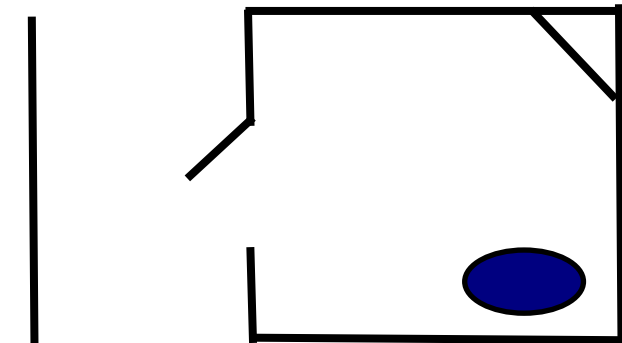

Left Thru-Floor



BOOM

Concrete, Inc.

Boom Concrete, Inc.
220 Girard Avenue
PO Box 437
Newell, SD 57760

Toll Free: 800-464-2600
Telephone: 605-456-2600
Fax: 605-456-6060
Website: www.boomcon.com
Email: lfox@boomcon.com

BOOM Clovermist Double

BOOM Clovermist Vault Toilet Pricing and Options

Clovermist Double precast concrete vault toilet with optional Colonial Dry Stack or Barnwood outside finish. Smooth interior walls will have two coats of modified acrylic water repellent penetration stain followed by one coat of anti-graffiti sealer, and a tan epoxy nonslip floor. Includes a 20" X 36" Lexon window and 18 ga. metal door. Doors and frames come factory powder coated teakwood brown. Two single compartment vaults, 5" floor slab, and 7/12 pitched one piece roof with cedar shake roof texture. Improved "Sweet Smelling Technology" design eliminates all odor associated with outdoor toilets. The Clovermist meets ADA accessibility requirements for persons with disabilities and has a 60" turning circle. Unit will be offloaded and set into owner supplied excavated hole at jobsite.



SIN # 361-10H
BOOM Clovermist Double Vault Toilet
Additional Options
Listed:

Commercial Price: \$22,000.00



Double Plastic Vault Liner



Raptor Vent Screen



Solar Light Kit



Waste Receptacle



1 Qt. Paint Kit



Chain Door Strap



Plastic Urinal



Solar Vent Fan Kit



Gojo Purell Hand Sanitizer Dispenser



Call for quote on transportation costs from Newell, SD
 GSA Contracts will receive a 3% discount on less than 10 units, 5% discount on greater than 10 units.
 Prices effective January 1, 2016